

LX 12/16

POWER AND CONTROL



LX DUPLEX

The LX series is an added value for handling professionals. Designed to efficiently meet the needs of more difficult applications, these machines combine a standard rich equipment and a high technological level, including the MOSFET electronic control, the separated excited traction motor technology (SEM) and a braking system with energy recovery.

LX INITIAL LIFTING

Apart from the LX series high capacity characteristics the initial Lifting models also offer the possibility to lift legs, hence facilitating the overcoming of ramps and knick points. These new models can also be used for the simultaneous transport of 2 pallets: one with the forks and one with the clamps.



LX-LATERAL LIFTING PISTONS

The LX series electric stackers are characterized by two cylinders allowing for a capacity of up to 1600 kg placed laterally to provide better visibility.



SIDE FRAMES

Apart from the upper cover, the battery compartment is equipped with removable side frames facilitating the replacement of the battery by the operator.



STEERING WHEEL AND CONTROLS

- Butterfly valve for traction control;
- Safety pushbutton with warning buzzer;
- Luminous indicator for battery state control and hour counter indicator.



Description

1.1 Manufacturer	LIFTER		
1.3 Drive	Electric		
1.4 Operator type	Pedestrian		
1.5 Load capacity	Q	Kg	1200
1.6 Load centre distance	c	mm	600
1.8 Load axle to end forks	x	mm	785
1.9 Wheel base	y	mm	1365

Weights

2.1 Service weight (battery included)	Kg	650
2.1 Service weight, With platform - battery included	Kg	NOT APPLICABLE
2.2 Axle load, laden rear	Kg	1232
2.2 Axle load, laden front	Kg	618
2.3 Axle load, unladen front	Kg	445
2.3 Axle load, unladen rear	Kg	205

Tyres/Chassis

3.1 Tyres: front wheels		RUBBER
3.1 Tyres: stabilizers wheels - Front		POLY.C.
3.1 Tyres: rear wheels		POLY.C.
3.2 Tyre size: Steering wheels - Width	mm	76
3.2 Tyre size: Steering wheels - Diameter	mm	250
3.3 Tyre size: Load rollers - Diameter	mm	82
3.3 Tyre size: Load rollers - Width	mm	70
3.4 Tyre size: stabilizers wheels front - Diameter	mm	125
3.4 Tyre size: stabilizers wheels front - Width	mm	50
3.5 Tyre size: rear wheels - Q.ty (X=driven)	nr	2
3.6 Tread, front	b10 mm	720
3.7 Tread, rear	b11 mm	410

Dimensions

4.2 Height, mast lowered	h1 mm	1965
4.3 Normal free lifting	h2 mm	1510
4.4 Lift height	h3 mm	1510
4.5 Height, mast extended	h4 mm	1965
4.6 Initial lift	h5 mm	NOT APPLICABLE
4.9 Height of tiller in drive position max	h14 mm	1390
4.15 Height, lowered	h13 mm	90
4.19 Overall length	l1 mm	1960
4.19 Overall length with lowered platform	l1 mm	2463
4.19 Overall length with raised platform	l1 mm	2052
4.20 Length to face of forks	l2 mm	810
4.20 Length to face of forks with lowered platform	l2 mm	1313
4.20 Length to face of forks with raised platform	l2 mm	902
4.21 Overall width	b1 mm	850
4.22 Fork dimensions - Thickness	s mm	70
4.22 Fork dimensions - Width	e mm	150
4.22 Fork dimensions - Length	l mm	1150
4.24 Fork carriage width	b3 mm	650
4.25 Distance between fork arms	b5 mm	560
4.26 Distance between legs	b4 mm	NOT APPLICABLE
4.32 Ground clearance, centre of wheelbase	m2 mm	20
4.34 Aisle width	Ast mm	2362
4.34 Aisle width with lowered platform	Ast mm	2872
4.34 Aisle width with raised platform	Ast mm	2415
4.35 Turning radius	Wa mm	1586
4.35 Turning radius with lowered platform	Wa mm	2096
4.35 Turning radius with raised platform	Wa mm	1639

Performance data

5.1 Travel speed laden	Km/h	5.5
5.1 Travel speed unladen	Km/h	6.0
5.1 Travel speed laden with platform in raised position or with raised forks	Km/h	2.5
5.1 Travel speed unladen with platform in raised position or with raised forks	Km/h	3.0
5.2 Lifting speed laden	m/s (strokes)	0.09
5.2 Lifting speed unladen	m/s (strokes)	0.15
5.3 Lowering speed laden	m/s	0.4
5.3 Lowering speed unladen	m/s	0.1
5.8 Max gradeability laden	%	5
5.8 Max gradeability unladen	%	10
5.10 Service brake		REVERSE CURRENT BRAKING

Electric motors

6.1 Drive motor power	kW	1.2
6.2 Lift motor power	kW	2.5
Battery type		Traction (C5)
6.4 Battery voltage	V	24
6.4 Battery capacity, Min	Ah	180
6.4 Battery capacity, Max	Ah	315
6.5 Battery weight, Min	Kg	190
6.5 Battery weight, Max	Kg	285
8.4 Sound level at driver's ear	dB(A)	67

On-board battery charger**Instruments****Miscellaneous**

*Available with double fork lifting control (optional)

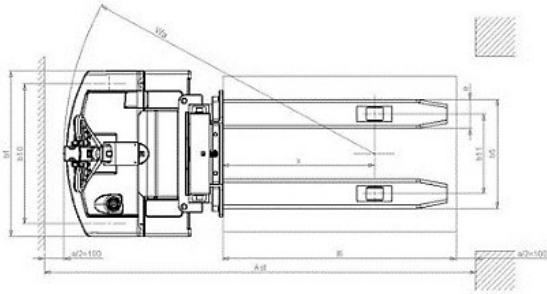
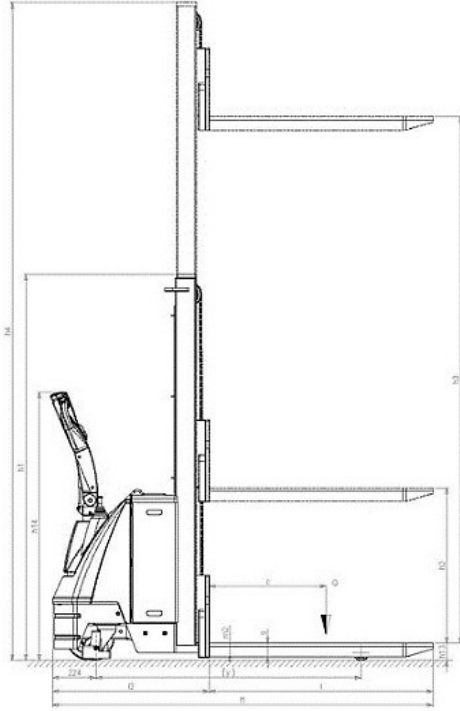

Printed on 16/07/2015 (ID 645)

©2012 | PR INDUSTRIAL s.r.l. | All rights reserved | Image shown may not reflect actual package. Specifications subject to change without notice | ENERGY GENERATION is registered trademarks of PR INDUSTRIAL s.r.l. Other company, product or service names may be trademarks or service marks of others. RevA (06/2012).

